



futureplants
perennial innovators since 1998

Achter de Watertoren 11
2182 DV Hillegom
The Netherlands



January 2025

Green Greetings!

In a world that moves faster every day, it's easy to forget that we are part of nature—not separate from it. The forests, the meadows, the quiet rivers—they speak to something deep within us. They remind us where we come from and offer a kind of peace no screen or city ever could. Nature grounds us. It soothes our stress, gives us strength, and helps us meet life's challenges with renewed clarity.

A garden may not be a wild woodland or a vast prairie, but it can become a gateway to that feeling. With care and intention, a garden has the power to recreate the quiet awe of standing beneath tall trees or walking through sunlit fields. It can give us that humbling, powerful sense of belonging.

We believe that gardening should not only bring joy but also respect the natural world it draws from. That's why we focus on sustainable growing practices, select hardy, long-living species, and aim to support biodiversity. Every plant in this catalog has been chosen not just for its beauty, but for its ability to thrive with minimal impact—and to give back to the ecosystem it becomes part of.

This catalog is an invitation to plant, to grow, and to reconnect. The perennial plants you'll find here are more than just beautiful additions to your landscape. They are part of a larger story. One that ties us back to the earth, season after season.

Kind regards,

Team Future Plants
Laura, Hein and Gerrit

Achillea ptarmica 'Dutch Delight'

Achillea

An important genus for the garden especially for its unusual inflorescence. A almost flat flower head. Very distinguishable and useful in design with numerous spike- and cluster-shaped flowers.

Achillea millefolium comes in a rich array of colors.

Watch out for the floppy ones though. And for the type that will seed throughout your garden! Interesting is the pure white *Achillea ptarmica* Dutch Delight. It's easy and vigorous. But will be well behaved in the garden and makes for an excellent cut flower.



Achillea millefolium Butterfly Bombshell

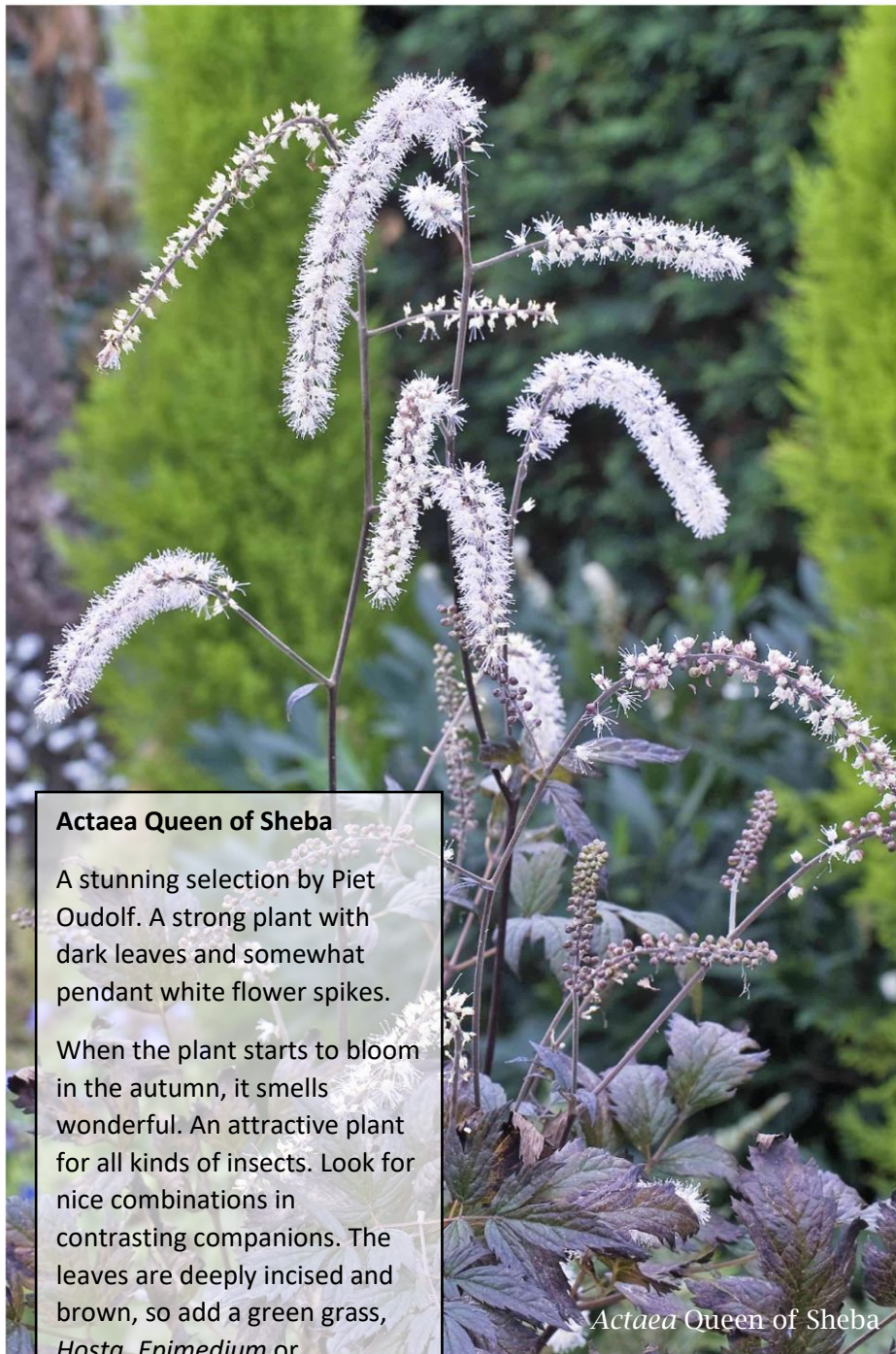

Actaea Queen of Sheba

A stunning selection by Piet Oudolf. A strong plant with dark leaves and somewhat pendant white flower spikes.

When the plant starts to bloom in the autumn, it smells wonderful. An attractive plant for all kinds of insects. Look for nice combinations in contrasting companions. The leaves are deeply incised and brown, so add a green grass, *Hosta*, *Epimedium* or *Polemonium*, for example.

Actaea Queen of Sheba



Agastache Danish Delight

A new introduction in 2021 this vibrant pink *Agastache* is a stunning addition to the Future Plants family.

Besides an intensely beautiful flower its vigour and vitality are exceptional. This is an absolutely hardy perennial and being an *Agastache* the smell in summer is amazing; sweet like anise or root beer.

As the name suggests, this plant originates from Denmark. The plant was grown as a seedling at Tina Møller's Nursery 'Staudemarken'.

Agastache Danish Delight



Anemone leveillei

Anemone leveillei

A bushy type of anemone with fingered leaves carrying pure white flowers that have a striking cluster in the centre of purple-blue helmet heads. A wonderful combination! Especially when the flowers close themselves in the fading light of the evening.

Anemone leveillei starts flowering in spring, as early as April. To top it all off, the spikey seed head is exceptional. Leave them and they will last you until October.



Anemone leveillei



Allium Millenium

Allium Avatar

Allium Avatar is a 2020 addition to the *Allium* program that Future Plants grows. Being a remarkable sport from *Allium Summer Beauty* this variety is best described as an allium on flower-steroids. Pushing out way more flowers and doing so way earlier and for weeks longer. It's smaller, shorter and more freely flowering. Excellent for container growing too.

Still hard to beat though are the phenomenal *Millenium* and the superb *Summer Beauty*. We will probably never stop growing these garden gems!

Allium Summer Beauty & Limonium latifolium



Allium Avatar



Astilbe Vision Vulcano



*Astilbe Vision in
White Delight*

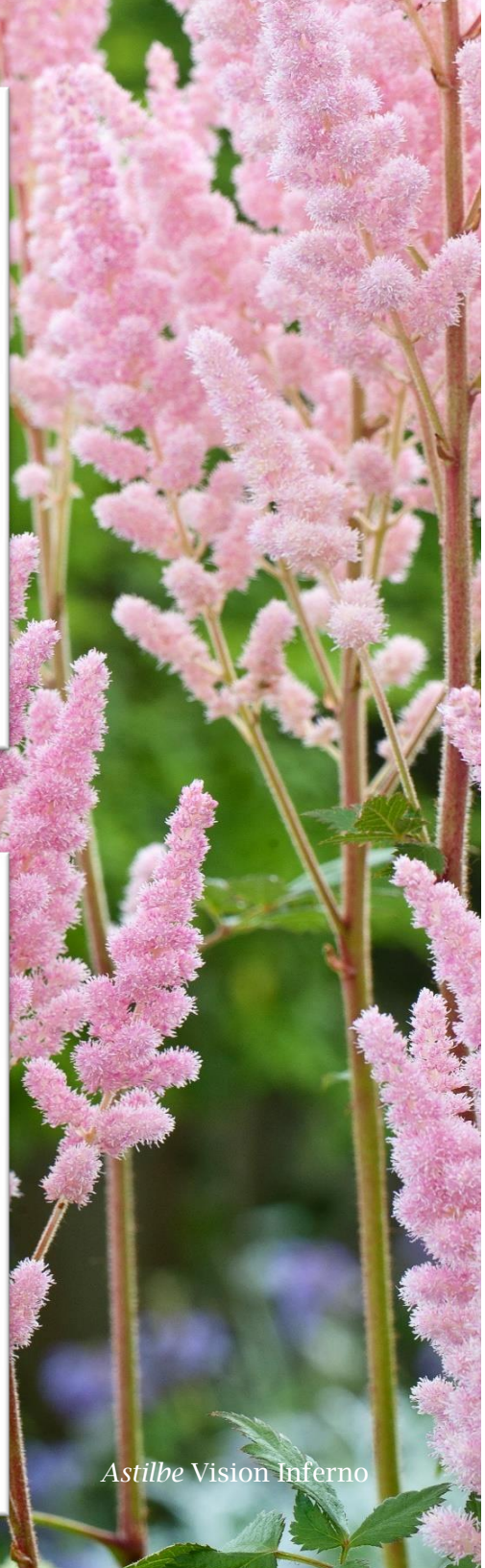

Astilbe Vision Inferno



Astilbe Vision Vulcano

Willem van Veen is the Dutch breeder of the valued *Astilbe* Vision-series. His latest introduction is the *Astilbe* Vision Vulcano. A gorgeous, richly filled flower in vibrant red carried by a dark stem flowering well above dark foliage.

Willem is one of Future Plants first third-party breeders and is still working on new selections. His focus will, as always, be on improving and enriching the assortment. Not only in color, but surely also in health and growing power. Something that make the Visions so incredibly popular with both gardeners and growers.



Astrantia major Capri

Astrantia Florence



Astrantia

One of those must-haves for every gardener! Delightful, old-fashioned flowers, but never out of fashion.

And if you haven't tried it, go for the *Astrantia Roma*. A strong variety that carries numerous antique-rose colored flowers. This plant has been the benchmark for Future Plants when it comes to selecting new cultivars for over 20 years.

A new star in the *Astrantia* family is Capri. As a direct descendant of Roma it displays the same health and flower-power. The color is a vibrant deep reddish-pink. It's an amazing garden plant, that can be cut back entirely, including leaves after flowering in spring. New foliage and flowers will appear within weeks. *Astrantia major* Roma, Capri and Florence all make for excellent cut flowers.

All species of *Astrantia* like fertile and moisture retentive soil.

Astrantia Roma

The High Line New York



Astilbe Vision in Pink



Echinacea Virgin



Salvia Eveline



Andropogon

A North American native grass with a big future. At least, that's what we believe.

Selections are becoming more useful because of increasingly better garden behavior. *Andropogon* Brocken Delight that originates from Free Spirit Nursery in Canada is the best example we've seen so far. It is sturdy and strong standing, flowers profusely and has proven to be extremely reliable. Also interesting for its darker foliage is the *Andropogon* Blackhawks, bred by Brent Horvath from Intrinsic Perennial Gardens.



Baptisia leucantha alba

Baptisia are beautiful plants that fortunately already enjoy quite a bit of fame. The plants themselves are very long lived and tend to grow somewhat slow at first.

The *Baptisia leucantha* is characterized by a stately, high inflorescence. The dark stems ensure that this prairie plant makes a majestic impression even more than other *Baptisia*.

The color in the autumn is almost deep black and then beautiful, thick seed pods are formed. Don't cut back... Enjoy! The plant will rid itself of the foliage when the time is right.

Baptisia leucantha alba





Dierama pulcherrimum

Dierama

Dierama is actually not a flower bulb, but a plant that grows from corms, which are closely related to bulbs. Both are simply underground storage organs for a plant, which contain the nutrients and embryo necessary for the plant to sprout.

Dierama pulcherrimum has sword-shaped leaves and has delicate bell-shaped pink to purple flowers, dangling from the stems.

Dierama pauciflorum has a shorter habitus. Delightful stubby-stemmed red-pink bells look out or upwards. Because of their alpine ancestry, it blooms in spring well before all other species.

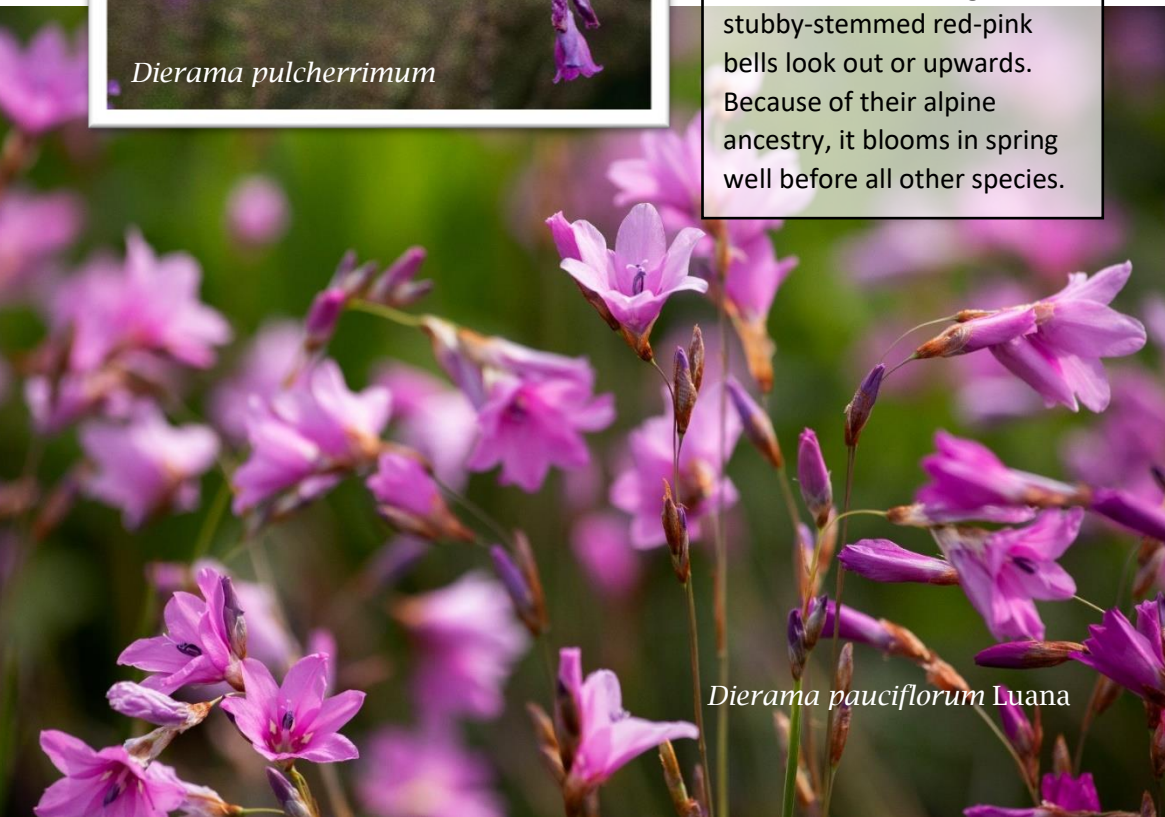

Dierama pauciflorum Luana



Echinacea purpurea Fatal Attraction



Echinacea Green Jewel

Echinacea

A classic from the North American prairie and known for that iconic cone in the middle. Unfortunately not so much for its durability!

The Future Plants varieties have been selected by Piet Oudolf himself, not only for their beauty, but also for their durability. They are the result of pure *Echinacea purpurea* breeding.

They might look somewhat simple, but these are well on their way to become classics in their own right. Plants like Virgin and Fatal Attraction form the basic range in the industry because of their reliability in growth and sales.



Echinacea purpurea Virgin

Laura & Piet Oudolf



In 2021 we were lucky enough to have Laura Fernald Ekasetya, former Director and Head Horticulturist at Lurie Garden in Chicago, join the Future Plants team. Besides working together Laura and Piet have been longtime friends. 'What stands out to me is her genuine interest in the plants and in a broader perspective in the entire environment and biodiversity within the garden. She has been a driving force behind Lurie Garden transforming from a planting into a living and thriving community where plants, trees, animals of all sorts, and people come together to enjoy the tranquillity and beauty of it.' According to Piet.

Laura is Account Executive for Future Plants and can be reached at laura@futureplants.com

The background of the entire page is a close-up photograph of several yellow Epimedium flowers. The flowers have long, slender, and slightly curved petals. Some are in full bloom, while others are still buds. The background is a soft, out-of-focus green.

***Epimedium* Amber Queen**

A true Queen indeed. Bred by Robin White, this amber-colored *Epimedium* has earned its place in the industry. Excellent garden performance and growth combined with stunning ternate foliage. Loved by growers for its reliability.



Epimedium Amber Queen

Eupatorium maculatum

Bring on those large umbel flowers in late summer! All *Eupatorium* species should attract masses of butterflies and bees. Essential to bring more life to your garden. This strong, large plant feels most happy in fertile soil, but will do well in most kinds of soil and will never let you down. Maybe after a decade or so, it is wise to dig them up and divide them so fresh growth can give them a new boost.

Most interesting are the white flowered *Eupatorium* Snowball and the dark stemmed *Eupatorium* Phantom.

Or when super-size is no problem for your garden, the *Eupatorium* Riesenschirm.



Eupatorium Phantom



Eupatorium Snowball at Vlinderhof

Geranium phaeum Joseph Green

A relatively new introduction of a particularly unusual but attractive hardy *Geranium phaeum*.

This chance seedling was first found in 2013 by Lynne Edwards in her own garden, in the UK. She named this beauty after her father Joseph Green who was a keen horticulturalist, specialized in botany.

Fully double purple-blue sterile flowers with what appears to be malformed stigmas in chartreuse green, interspersed, and most prominent as the flowers open.

So far it has been very rare in trade. We feel it's way too beautiful to be that exclusive! This desirable plant deserves to be enjoyed in every garden.



Geranium phaeum Joseph Green



Geum

These spring flowering plants are true garden gems. The semi-double red *Geum* Flames of Passion and the soft apricot pink *Geum* Mai Tai (bred by Brent Horvath) are two well-known Future Plants varieties.

Geum tends to form tight ground-hugging clumps. Above the fresh green foliage the nodding flowers will bring joy to your plantings. Most flower color tend to be towards the warm end of the spectrum. The *Geum rivale* is irresistible to the early appearing bumble bees. We feel the *Geum rivale* might bring an improved garden life over the *Geum chiloense*. The latter is widely used in more recent introductions. To us, garden performance will be essential in new breeding.



Geum Mai Tai



Geum Battenberg Cake



Geum Jam Roly-Poly

NEW FOR 2025



Geum Victoria Sponge



Geum Cherry Bakewell



Echinacea & Allium



Laura



Lurie Garden Chicago



Lythrum virgatum Happyness

Lythrum

Straight from the Oudolf gardens at Hummelo, two new introductions: *Lythrum* Happyness and Joy.

Lythrum is a wetland plant that will basically thrive in any kind of garden soil. Worthwhile for their long flowering season and the bold colors.

Lythrum virgatum and *Lythrum salicaria* are invasive across North America. An attractive substitute would be the native *Lythrum alatum*.



Lythrum virgatum Joy



Molinia

An easily recognizable grass growing in dense clumps. *Molinia* is commonly found on wet to moist soils. It only blooms in summer with long, rather stiff culms, which have a single knot at the bottom of the culm.

After flowering, the spent culms of *Molinia caerulea* will stay upright in the clump until spring.

The *Molinia arundinacea* will lose its spent culms in December after the first frost .

This makes the grass easily recognizable even outside the flowering period.



Molinia Dark Beauty

Monarda

Or beebalm. A plant with an extremely artistic flower shape, and with a spicy aroma that is delightfully recognizable. Although the genus has a rich assortment of pink shades, there are also other colors from red to lilac and even deep purple.

One of the difficulties in *Monarda* is the susceptibility to powdery mildew. Strong varieties that grow well can certainly offer added value with their recognizable seed heads in winter. Don't cut back too soon!



Monarda Purple Lace

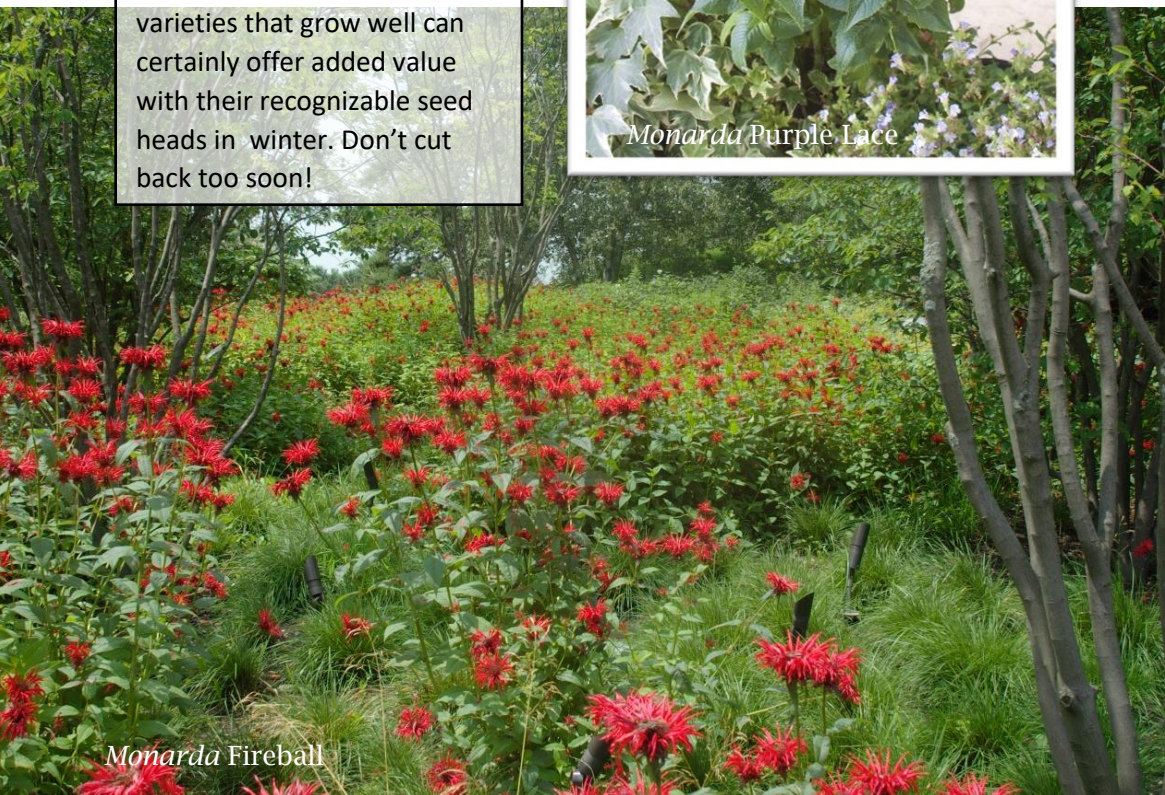

Monarda Fireball



Panicum virgatum Purple Tears

***Panicum virgatum* Purple Tears**

Panicum virgatum Purple Tears bears flowering spikes with soft grey color at the top, followed by splendid, purple seed heads. With a manageable height of 130 cm, its narrow, upright habit makes it perfect for a range of landscape applications. It has the same toughness and adaptability you'll find in other switchgrass cultivars.



Oudolf	Garden	Detroit
--------	--------	---------



Paeonia emodi

Paeonia emodi

A rarely offered peony, which has its origin in the mountains of Kashmir. The beautiful, pure white flowers that are small and single, bear distinctive golden stamens. The habit of this plant is different from what people are used to. The plant, with a height of about 70 centimeters, forms a dense, almost shrub-like green foliage. It gets covered with white flowers. Often multiple per branch, which also bloom consecutively, so that the total flowering period tends to be very long.



Papaver King Kong



Papaver orientale

The oriental poppy is a perennial plant native to Central Asia.

The finely incised leaves dry up after flowering. This is an adaptation to the dry, hot summers in Central Asia. To prevent open spaces from forming in the border in summer, it is best to interplant *Papaver orientale* rather than plant it in large groups. That way surrounding plants will fill in the bare space left behind. The leaves come out again during the autumn rains.



Papaver White Ruffles



Persicaria Flamingo Feathers

Persicaria amplexicaulis

If it were up to us, we would try every single *Persicaria amplexicaulis*. It is without a doubt the most beloved *Persicaria*. They are certainly among the most valuable late summer bloomers and they seem to bloom more profoundly with increasingly intense colors in the course of the autumn.

Chris Chyselen is the breeder of *Persicaria* cultivars such as Blackfield, Orangefield and Fat Domino. But more so, he has been an inspiration when it comes to the use of these phenomenal plants. His participation in the Great Dixter and Sussex Prairie Gardens Plant Fair paved the way for many. Not to mention his own Oostveld Gardens in Belgium.

Persicaria amplexicaulis Alba





Perovskia Little Spire

Perhaps a bit of an exception as a semi-shrub.

Perovskia Little Spire should be taken back just a little above the ground every year. It flowers on the annual wood. There it forms graceful branches with small, greyish leaves and thin plumes full of lilac-blue flowers.

This plant from the Central Asian steppe is very resistant to the extreme climate conditions that we have to deal with more and more.

Perovskia Little Spire is famous for its shorter growth habit which keeps it from becoming floppy.



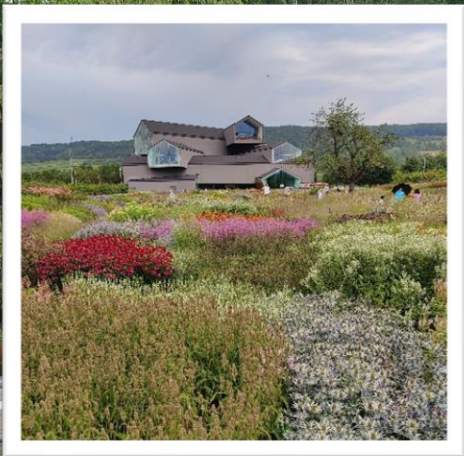

VITRA Campus at Weil am Rhein (Germany)



Glycyrrhiza yunnanensis

Glycyrrhiza yunnanensis

Glycyrrhiza yunnanensis is a perennial shrub-like plant that originates from China. This impressive plant has beautiful featherlike foliage. Purple-blue flower clusters appear from the leaf axils. But most admirable are the seed pods: spiky and brown-haired they offer decorative garden value well into winter.

Rudbeckia

Rudbeckia is a beautiful North American native that has produced a large number of stunning cultivars.

Most famous of all *Rudbeckia* is Goldsturm. Although many are grown from seed, we still propagate our own stock vegetatively solely by division.

This unique line originates from Arnoldshof, Germany and can be traced back all the way to Karl Foerster who named *Rudbeckia* Goldsturm. 'Better does not exist' he supposedly said and that may well be true. The plant is widely used in gardens as well as in public spaces throughout the world.



Rudbeckia Black Beauty



Rudbeckia Goldsturm

Salvia Pink Serenade



Salvia Pink Serenade

With its extended flowering season stretching from May all the way into September, and its irresistible charm to pollinators, *Salvia sylvestris* Pink Serenade is a true must-have for your garden.

With larger internodes, Salvia Pink Serenade creates impressive flower spikes that can reach up to 80 cm in height. This is a true perennial, known for its sturdy stand and dependable performance year after year.



Salvia Madeline

Sanguisorba

A strong and very forgiving perennial plant. The number of cultivars has expanded greatly in recent years especially due to the cut flower industry.

New to the Future Plants range is a firm growing white *Sanguisorba officinalis* called Jam Session. It grows about 1 meter tall. But there are so many garden gems among the species. The short *Sanguisorba* Proud Mary, the elegant Blackthorn or species *Sanguisorba canadensis*.

Keep away from the cut flower breeding though. They are too floppy for use in gardens and will need a lot of support.



Scutellaria incana

Scutellaria incana, common name Skullcap, is a undervalued garden plant. This sturdy North American plant makes clusters of small flowers, resembling tiny baseball caps.

After introducing the pure white 'White Sky' and the dark Blue 'Night Sky', Future Plants now introduces *Scutellaria incana* Evermore. White, with purple centre lines, giving it a pink glow. Seed heads on the *Scutellaria* bring extra value to the garden.



Scutellaria incana Evermore



Scutellaria incana seed head

Schizachyrium scop. Ha Ha Tonka

Little bluestem, selected by Cassian Schmidt and Piet Oudolf in Hermannshof, Germany.

Dense, fine hairs on the leaves softly catch the light and create a unique halo effect. It glows like no other grass we've ever seen before. And just imagine how this presents itself when small drops of morning dew collect on those fine hairs. The foliage is blue-green with segments of red and grey.

Ha Ha Tonka has a neat, rigid and upright habit.



Schizachyrium scoparium Ha Ha Tonka

Sedum Xenox series

A plant with a long flowering time. A strong variety in the extensive range of *Sedum*. Combined with other foliage plants and flowering plants, its dark red foliage comes into its own. The plant starts growing early in the spring. For use in plantings think of combinations with the ornamental grass such as *Hakonechloa* or a perennial like *Calamintha nepeta subsp. nepeta*.

The pink flowering Xenox has related cultivars in Yellow Xenox and Orange Xenox.

Like most *Sedum*, this plant prefers dry, well-drained soil.



Sedum Xenox



Sedum Orange Xenox

Sesleria heufleriana
Norðic Overdam Blue

This new bluegrass was discovered by Poul Petersen at his nursery Overdam Planteskole. The upper side of the foliage is blue-green and the underside is steel blue. The spiral growth pattern of the leaves gives the plant an overall grayish appearance. Since the leaves are wider, Sesleria 'Overdam Blue' appears to be both more lush and vigorous than the species. It blooms in early spring with upright spikes that are first black and later change to a cream-color. It is a very good ground cover grass. Its beautiful appearance also makes it suitable as a pot plant.

Sesleria Greenlee Hybrid

What we prefer in the Greenlee Hybrid is its neat behaviour. *Sesleria autumnalis* tends to overgrow itself on rich soil. Not so with the Greenlee Hybrid. It makes beautiful evergreen mounds with cream-colored flower spikes well placed just above the blue-green foliage. It seems to be more tolerable to heat and extreme weather conditions in general.

Sesleria heufleriana
Norðic
Overdam Blue



Sesleria Greenlee Hybrid

Sidalcea Candy Girl

***Sidalcea* Little Princess**

The pleasant, pale-pink color and the large flowers that are arranged neatly around the stems along with the sturdy growth habit make this an absolute winner.

For some height is important. Well, the *Sidalcea* Little Princess is the shortest *Sidalcea* around! Perfect for container growing on your patio. Or to scatter around in a grass matrix planting with *Sesleria* or *Bouteloua gracilis*.

Stronger colors are available too. *Sidalcea* Candy Girl being one of them.



Sidalcea Little Princess next to *Sidalcea* Candy Girl

Stachys Summer Snowcone



Stachys (also known as Betonica)

Following the smaller, soft pink *Betonica officinalis* Summer Sweets are the purple *Summer Grapes* and the white *Summer Snow*. All excellent for container growing or for a lower part in a planting. Its dark green leaves already appear in early spring and will remain till first frost hits. The spike-shaped flowers grow on short, sturdy stems and protrude gracefully above the foliage.



Stachys Lilac Lady

A bit taller but very useful in landscaping, the new *Stachys Lilac Lady* offers a softer lavender haze that is easier to combine than the traditional *Stachys Hummelo*.

Restaurant nomra Copenhagen



Horticulturist Liv Holm

Glycyrrhiza yunnanensis & *Echinacea Virgin*



Veronica

The characteristically long flower spikes come in an array of colors. This ornamental plant that blooms from June into August is not only popular with gardeners, but also with insects, especially bees and bumblebees. *Veronica* is also loved by butterflies. Prune away faded flowers as soon as possible, this increases the chance of a second bloom.

Veronica longifolia makes for an excellent cut flower.



Veronica CanCan



Veronicastrum Springdew

Veronicastrum

Same family as *Veronica*, but bigger in every way. Crosses between the two can no longer be ruled out. Its strong upright habit truly emphasizes those vertical lines in your planting. *Veronicastrum sibiricum* such as Cupid are typically a bit earlier in flower, but combine them with the *Veronicastrum virginicum* and these long-lived plants will amaze you time and time again and for years to come!

The overall quality of the cultivar has been improved immensely compared to the old *Veronicastrum Alba* and *Rosea*. Not only in color, but surely also in habit. *Veronicastrum* Challenger is proof of that. Its compact growth makes for a stand as solid as a tree! Keeping up its form throughout winter, the silhouette brings new stature to the garden.



Veronicastrum virginicum Challenger



In 2017 we were introduced to one of the most joyfull people in the industry, Mr Lee Hyun Su from Chunjee Nursery in South Korea. Hyun Su is a fan of the Natural Garden style and a passionate follower of the work of Piet Oudolf. Having a nursery in South Korea and a great team of workers at hand, he was the man to convince Piet to take on a project in Taehwagang National Garden in Ulsan City. We went out to meet with Hyun Su and his team in 2022 to see their operations and facilities. Even though Korea still seems to be a relatively new or young market, we were greeted with gracious hospitality and shown a unparalleled level of enthusiasm and professionalism. We are overjoyed that Chunjee Nursery is now holding a licence to produce Future Plants varieties and is representing us in Korea.

정말 고마워 친구들



*Hummel august 24
2017*

Piet Oudolf

Oudolf's design

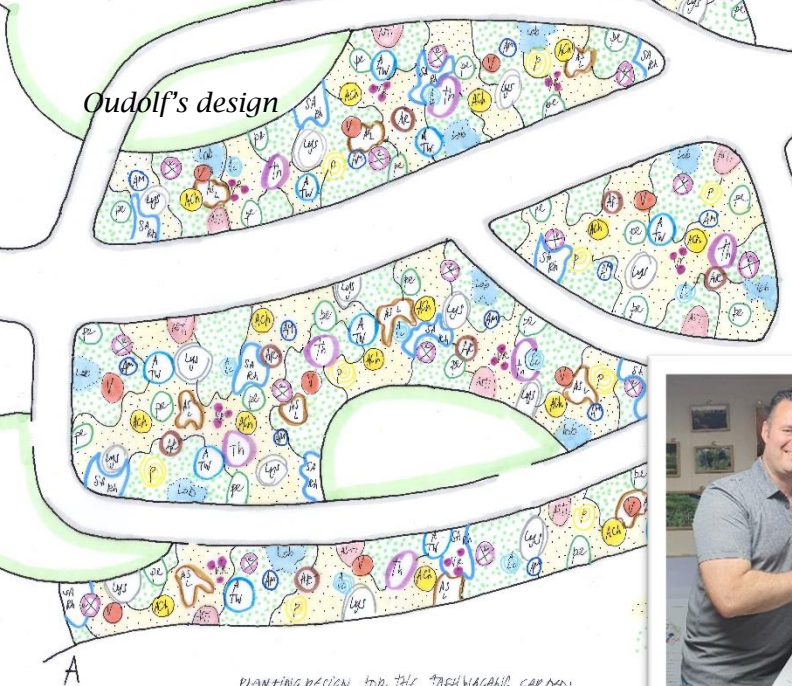

- ASTER LITTLE CARLOW
- ASTER TWILIGHT
- ASTER DELFT LACE
- ELSCHOLTZIA STAUNTONII
- LOBELIA SESSILIFOLIA
- LYSIMACHIA CLETHROIDES
- PACHIRA AQUATICA
- PERSICARIA AMPLEXICAULIS
- SAVARIA RHOMBOIDES

PLANTING DESIGN FOR THE TREHWAGLAN GARDEN
BART HOGS & PIET OUDOLF
SCALE 1:100 METRIC

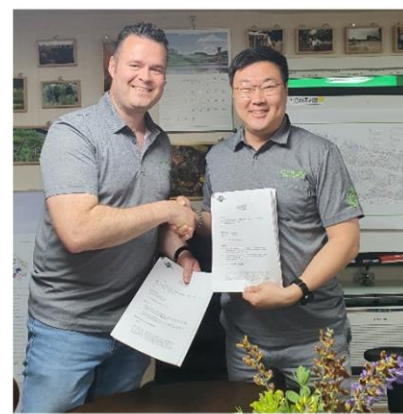

Chunjee Nursery in South Korea



The Future Plants Trial Garden – A Living Laboratory of Innovation

In June 2024, Future Plants unveiled its new trial garden in Lisse – a unique space where horticultural innovation and natural beauty meet. Situated on Loosterweg Noord, in the heart of the Dutch flower bulb region, this 2,300 m² garden is more than a showcase; it's a living laboratory designed to inspire, educate, and connect.

Created in collaboration with world-renowned designers Piet Oudolf and Stefano Marinaz, the trial garden blends artistry and function. The layout reflects a plant-driven philosophy, encouraging visitors to slow down and explore the rich diversity of species on display. Slightly mounded planting beds create subtle microclimates and lift specimens into view, while strategically placed seating areas invite moments of reflection and close observation.

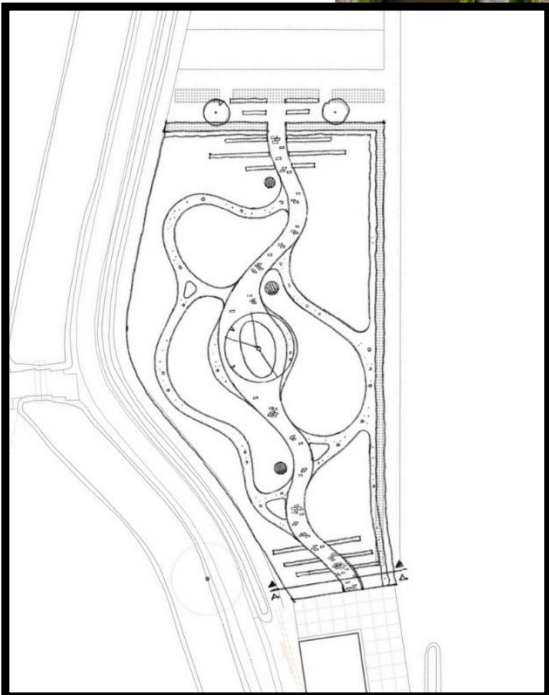

As you walk through the garden, you'll encounter over 200 varieties of perennials and ornamental grasses – from innovative new introductions to time-tested species that have proven their worth in naturalistic plantings. Here, visitors can study growth habits, flowering times, and seasonal silhouettes, gaining insight into how these plants perform throughout the year. The garden has been designed to evolve over time, transforming as new varieties are introduced and established. This dynamic character ensures each visit offers fresh inspiration.

The trial garden is also a practical resource for growers, retailers, designers, and horticultural professionals. It highlights plant combinations and compositions that demonstrate aesthetic potential, ecological value, and adaptability to changing climates – key considerations for contemporary landscapes. As Stefano Marinaz notes, the design “bridges the gap between growers and designers”, creating a forward-thinking platform for botanical exploration.

Parts of the garden are already flourishing, while others remain in progress as planting continues. This sense of ongoing development reflects Future Plants' commitment to innovation and experimentation – a garden that is alive in every sense.

We warmly welcome growers, sales professionals, retailers, and wholesalers to visit and experience the garden firsthand. By appointment during office hours, you can explore a space where plants tell their stories and ideas for future landscapes take root.

Come and discover the Future Plants Trial Garden, where the future of planting is growing today.

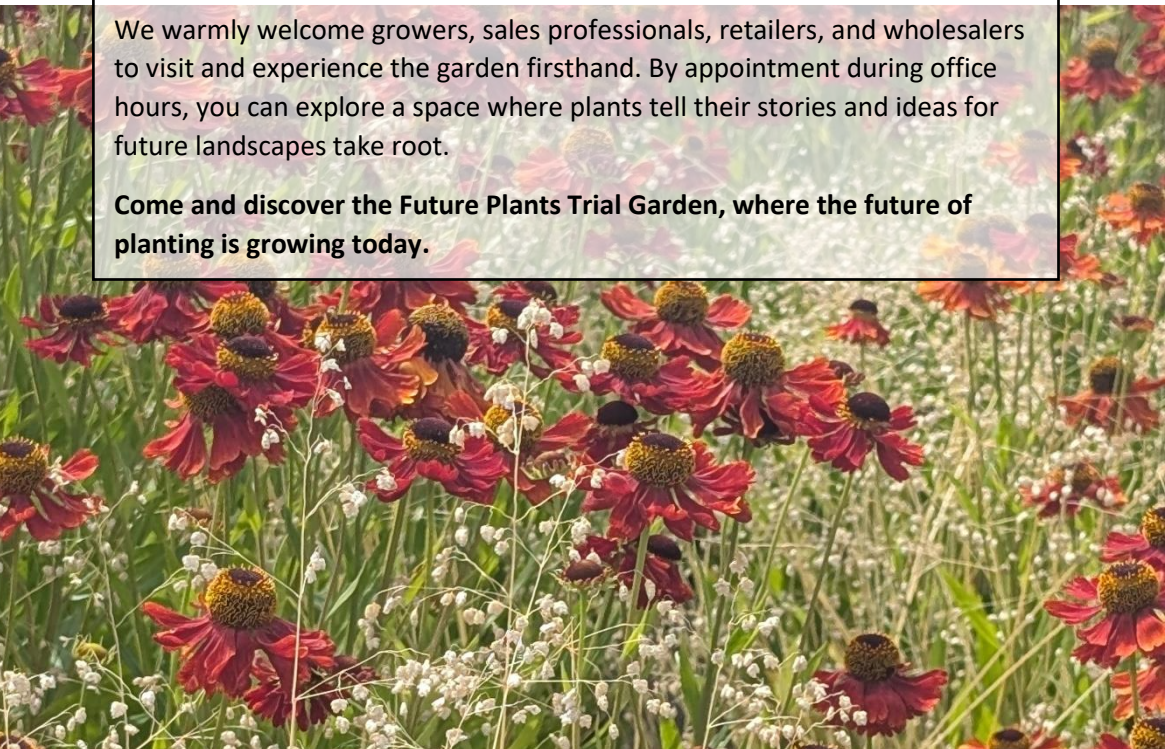



Top Ten – New & Exciting Perennials and Grasses

Every season brings a wave of new varieties, but some stand out for their beauty, versatility, or sheer wow-factor. In this special selection, I'm sharing my personal Top Ten – a handpicked collection of perennials and ornamental grasses that I find particularly inspiring for today's gardens and landscapes.

These are plants that combine strong garden performance with striking aesthetics. From fresh introductions with unique colors or forms to reliable workhorses reimagined for modern plantings, each has earned its place on this list.

For each, you'll find a detailed description and a photo to help you explore their potential. Whether you're looking for bold statements, subtle textures, or ecological value, I hope these favorites spark ideas and encourage you to try something new in your plantings.



Phlox paniculata UNNAMED

A true garden gem with stable variegation. In spring, its foliage emerges in a striking mix of **fresh green, creamy white, and warm red hues**, followed by airy clusters of cool blue blooms in summer. Perfect for borders and pollinator-friendly gardens.

Height: 80 – 100 cm

Position: Full sun to part shade

Moist, well-drained soil

Astilbe UNNAMED

A breakthrough in Astilbe breeding. With its rich, dark foliage and exceptionally **well-developed, vibrant pink plumes**, this variety stands apart from others like Astilbe Chocolate Shogun. Thanks to its **Visions lineage**, it combines **stability, vigor, and stunning garden performance**. Not yet ready to hit the market, this promises to be a true statement plant for shade borders and mixed plantings.



Callirhoe

Rarely seen in the perennial plant world, **Callirhoe** deserves a place in modern landscapes. With its **exceptional drought tolerance** and graceful habit, it's ideal for sustainable, low-maintenance plantings. Our breeding efforts focus on refining its garden behaviour and introducing **softer, more versatile shades** beyond the bold pink, making this North American native beauty even more valuable for contemporary designs.





Phlox paniculata 'Sweet Laura'

A fragrant star with a story. This pink-flowering beauty fills the garden with a **delicious, sweet scent** and masses of vibrant blooms through summer. Originating from the famed Lurie Garden in Chicago and named for its former director, Laura Ekasetya, it's a variety that blends **romance, resilience, and irresistible fragrance**.

Height: 100 – 110 cm

Position: Full sun to part shade

Moist, well-drained soil



Sesleria 'Nordic Overdam Blue'

We expect more improved Sesleria varieties will be introduced soon. This one, selected by Poul Petersen, stands out to impresses with its **refined size** and striking **steel-blue foliage**, bringing cool elegance to modern plantings. As Sesleria continues to evolve with new and improved forms, 'Nordic Overdam Blue' sets the tone as a **versatile, resilient, and stylish addition** to the garden palette.

Stachys 'Lilac Lady'

A fresh take on a well-known garden favorite, Stachys Hummelo.

With its soft **lilac blooms**, this healthy, easy-care perennial offers a gentler alternative to the bold purples of Hummelo. The more refined color makes it **perfect for elegant combinations** in borders, mass plantings, and modern landscapes. Resilient, versatile, and beautiful.

Height: 60 – 80 cm

Position: Full sun to part shade

Moist, well-drained soil



Andropogon 'Blackhawks'

This striking North American native brings a fresh dynamic to planting schemes with its **dark, dramatic foliage** that deepens to rich **reds and purples in autumn**. Topped with elegant flower spikes, it adds both **color and movement** to the landscape. Still relatively unknown in Europe, 'Blackhawks' deserves to be discovered as a **resilient, low-maintenance grass** perfect for modern designs and naturalistic plantings.





Veronicastrum virginicum

Our breeding program is setting new benchmarks for **strength, vigor, and color** in *Veronicastrum virginicum*. Building on the success of **‘Challenger’** with its stronger, upright stems, we’re selecting for varieties with **robust growth, deeper, more vibrant colors**, and improved garden performance. The result: striking architectural perennials that combine beauty with resilience—perfect for modern landscapes and pollinator-friendly plantings. Coming soon!



Astilbe ‘Vision in White Delight’

At last, the Vision series has its white counterpart that growers have been waiting for. **‘Vision in White Delight’** matches the **vigor and production power** of Vision in Pink and Vision in Red, solving a long-standing challenge in production. With its **profuse, striking white plumes** and robust growth habit, it stays true to its Vision heritage while raising the bar in performance and garden impact.

Geum - A Delicious New Series

Introducing a new generation of Geum, carefully bred for **exceptional durability, strong vigor, and garden-worthy performance**. This charming series delights with **large, refined blooms** in a delectable palette—deep reds, soft pale pinks, creamy whites, and fiery orange tones kissed with gold. Named after classic English pastries, **‘Jam Roly-Poly’, ‘Battenberg Cake’, ‘Cherry Bakewell’, and ‘Victoria Sponge’**. Each variety adds a touch of whimsy and sophistication to perennial plantings. With their robust nature and long flowering season, Geum is perfect for borders, cottage gardens, and contemporary landscapes alike. Indulge in this irresistible collection and bring a taste of elegance and color to your garden.

Have a taste of these new garden jams and sweeten up your borders!





Gerrit Lommerse (owner)
gerrit@futureplants.com



Laura Fernald (Account Executive North America)
laura@futureplants.com



Hein Lommerse (owner)
hein@futureplants.com



+31 (0)6 20134296



info@futureplants.com



futureplants.com



future.plants

Credits: In compiling this catalogue we have used images and information from various photographers and sources. Our special thanks goes out to Piet Oudolf, Hans van Horssen, Tina Møller, Chris Ghyselen, Willem van Veen, Knoll Gardens UK, Laura Fernald-Ekasetya, Stefano Marinaz L.D. and Chantal Vastenhout.



The information in this catalogue is to be used only as a guide to assist with product selection.

The plant varieties listed can be protected varieties which makes reproduction and propagation illegal. Please inform at Future Plants whether such protection is applicable.



futureplants

**piet
oudolf**
collection